

Instruction Manual for InvisiDoor Hinge Kit Installation

Hinge Kit Includes:



Looking for more assistance? Scan here for more details on how to install your InvisiDoor hinge kit, including how to build your own InvisiDoor.



Installation Tools Needed:

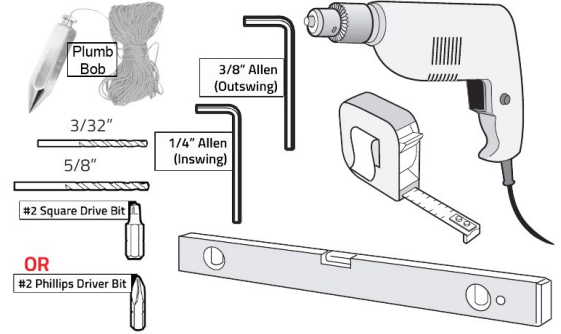

Constructing your InvisiDoor-way:

Ensure that the finished wall is no more than 6" thick.

Confirm that the threshold or floor will provide adequate support for the weight of the unit and its contents. Solid hardwood is strongly recommended.

Frame a rough opening with interior dimensions that are 3 inches larger than the width and height of your InvisiDoor's face frame.

Using the InvisiDoor Jamb (made with 3/4" solid wood) and any necessary shims, create a finished opening that is exactly 1" wider and taller than the face frame of your InvisiDoor. It is important to the operation of the door that this opening be plumb and level.

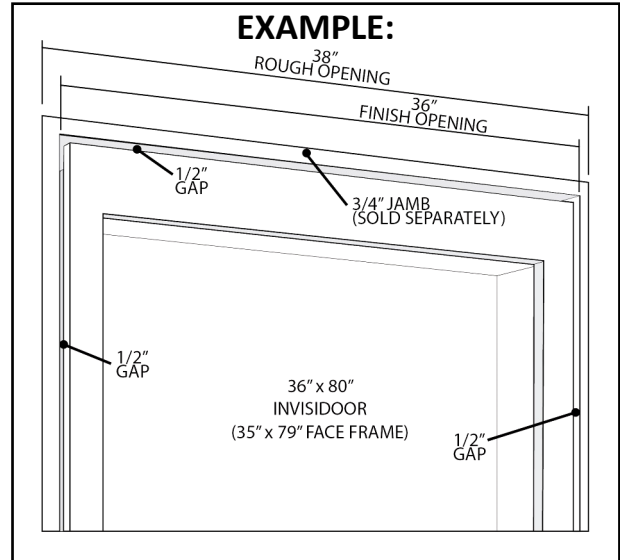

Preparing your InvisiDoor for Installation:

It is recommended that installers test mount all hardware to their door before applying any finish to avoid potential damage.

Using the diagram, identify the locations for the pivot hinge to be installed as either "outswing" or "inswing." The face frame of your InvisiDoor should mount flush with the surrounding drywall.

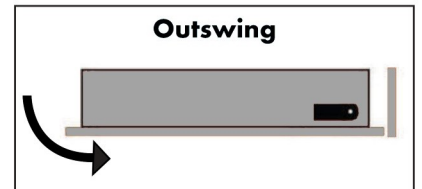
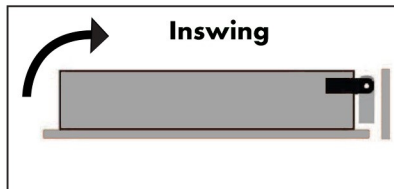

Hinge Plate #1

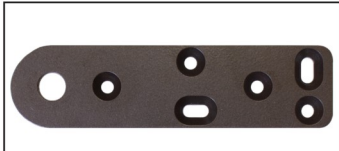

Bottom of the bookcase

Hinge Plate #2

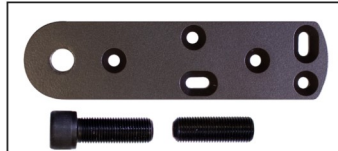

Threaded hole, mounted to the top of the bookcase

Hinge Plate #3

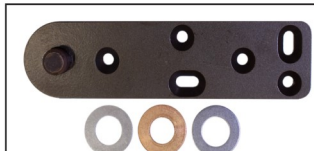

With attached pivot pin and washers, mounted onto the threshold

Hinge Plate #4

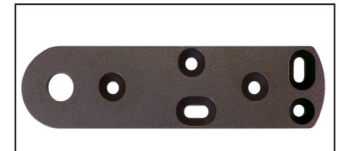

Mounted to the upper door jamb

Using the diagram for reference, install Hinge Plate #3 to the threshold or floor, using the included 7/8" screws in the two slotted holes. Place the bronze bearing in between the two steel washers and place them on the hinge pin.

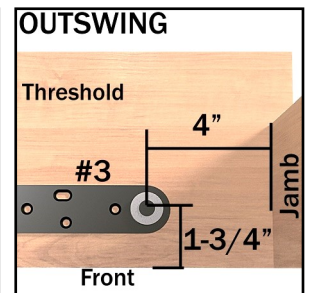
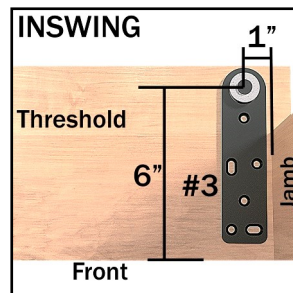

According to the diagram, install hinge plate #4 to the upper jamb, using 2 of the supplied 2 1/2" screws in the slotted holes. If needed, place shims between the jamb and header to help secure the hinge plate. Use a plumb bob to confirm that the pivot pin on hinge plate #3 aligns with the hole in hinge plate #4.

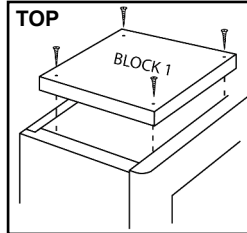
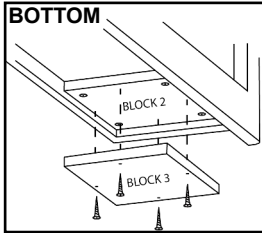
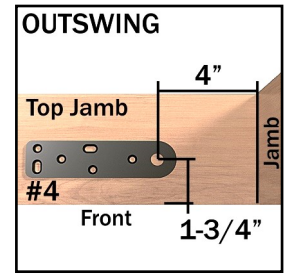
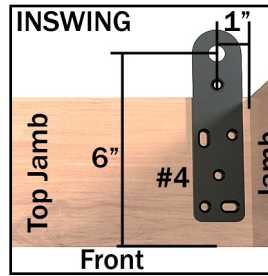

According to the diagrams, use the supplied 7/8" screws to install mounting blocks to the hinged side of the bookcase. This will make hinge plates #1 and #2 level with the top of the face frame once they are installed.

According to the diagram, using the supplied 7/8" screws in the hinge plate's slotted holes, install hinge plate #1 to mounting block on the bottom of the bookcase.

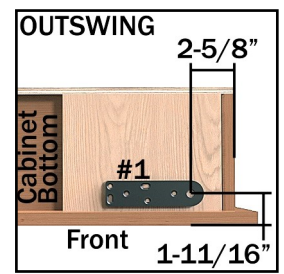
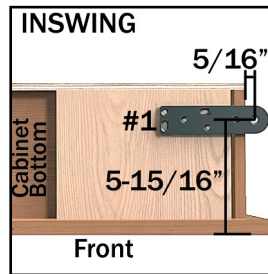

According to the diagram, using the supplied 7/8" screws in the hinge plate's slotted holes, install hinge plate #2 to the mounting block on the top of the bookcase. If the door is an "outswing" application, note that a through-hole must be drilled for mounting.

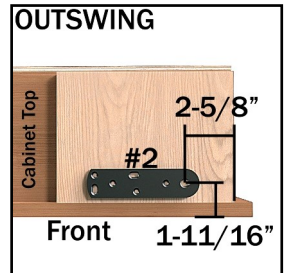
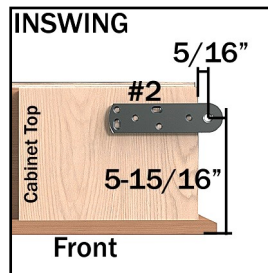

Lift the bookcase into the opening, and set the hinge plate #1 onto the pin of hinge plate #3.

Align hinge plate #2 with hinge plate #3. For INSWING APPLICATIONS, thread the cap screw downward through hinge plate #3 and into hinge plate #2. For OUTSWING APPLICATIONS, apply Loctite to the threads of the set screw and use the access hole drilled earlier to screw it upward into hinge plate #2 and #3.

Verify that the door operates properly and use the remaining 2" and 7/8" screws to completely affix the hinge plates in their mounting locations.

Trim Installation:

It is recommended that any trim overlay the face frame by 1/2" - 3/4", and that the trim be at least 3/4" thick. The trim will serve as a stop for both inswing and outswing applications, but be sure to apply the trim in such a way that it does not interfere with the function of the door.

Support Foot Installation:

Using the included 3/4" screws, affix the support foot bracket, threaded hole down, to the side of the bookcase opposite the hinges. The bracket must be attached near the face frame to allow enough clearance to swing past the jamb. Use the included bolt and hex nuts to create a support, and align the tapered stop so that the bolt rests on the tapered stop when the door is closed.

The InvisiDoor system carries a maximum weight rating of 300lbs, including the weight of the bookcase (approximately 70lbs).

